

# Create a healthier, more comfortable home with the **Comfospot 50**



The **ComfoSpot 50** is a compact and discrete heat recovery ventilation unit that is ideal for single rooms and small living spaces. Its efficient enthalpy exchanger achieves excellent thermal energy recovery while maximising indoor comfort and creating healthier indoor living spaces.



**FANTECH**  
Intelligent Ventilation

*Creating healthy buildings with*  
**zehnder**

# Fresh air through continuous ventilation

The decentralised ComfoSpot 50 includes a unique and highly efficient enthalpy exchanger that extracts the thermal energy from the exhaust air whilst reducing indoor moisture and odour. The exchanger is easily cleaned with water and its membrane prevents odours from being transferred from the exhaust to the supply air.

The modern and ultra slim design of the ComfoSpot 50 features an easy to use control panel that is integrated into the unit housing.

## Innovative design & efficient operation

The ComfoSpot 50 provides a well ventilated indoor space with simple and quiet operation. Its housing is made of heat retaining and noise attenuating EPP (expanded polypropylene) material which maximises energy recovery while reducing noise output. ComfoSpot 50 comes fitted with two G4 filters (upgradable to F7) that are easily replaced from inside the living space. It also comes with a high quality EC motor driven fan that ensures efficient operation and reliable performance.

Installation has been made easy with the ComfoSpot 50, as it only requires a main power supply and a single wall penetration. There is no need for a condensate drain and base plates simply mount to the wall making fitment easy. Having all the technology hidden within the wall allows the system to be completely duct free and retain its sleek contemporary look.

European Made



Heat Exchanger



Energy Saver



Quiet Operation



Optional Humidity or CO<sup>2</sup> Sensor



## Features

- Intuitive control panel provides 4 speed fan adjustments and operation of supply/exhaust air
- Provides continuous fresh air at a maximum 55 m<sup>3</sup>/h air flow volume
- G4 filter supplied as standard, optional F7 supply air filter also available
- Supply and exhaust air openings can be closed off manually if required
- Works in temperatures as low as -5°C without the need for a preheater
- Filter replacement alerts makes maintenance easier
- Achieves up to 82% heat recovery and up to 78% humidity recovery
- Optional humidity and CO<sub>2</sub> sensor boards to change its air flow volume according to demand



*Its enthalpy exchanger enables up to 85% heat recovery*

## Quick and easy operation

- Intuitive operation via the control panel located at the top or bottom of the Comfospot 50.
- Filter replacement indicators located on the panel.

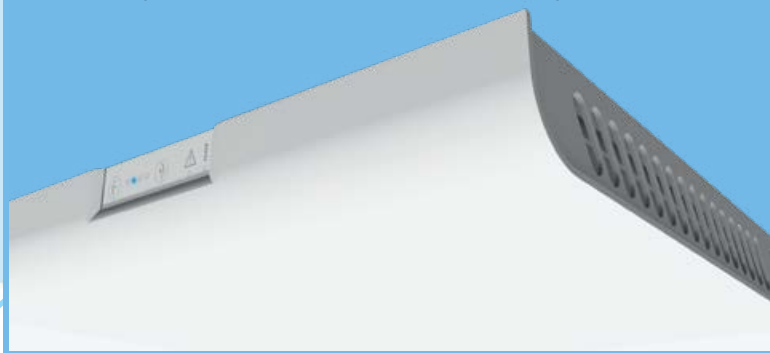

## External grille options

The Comfospot 50 comes with an external ABS grille as standard or can be upgraded to stainless steel for more demanding conditions.

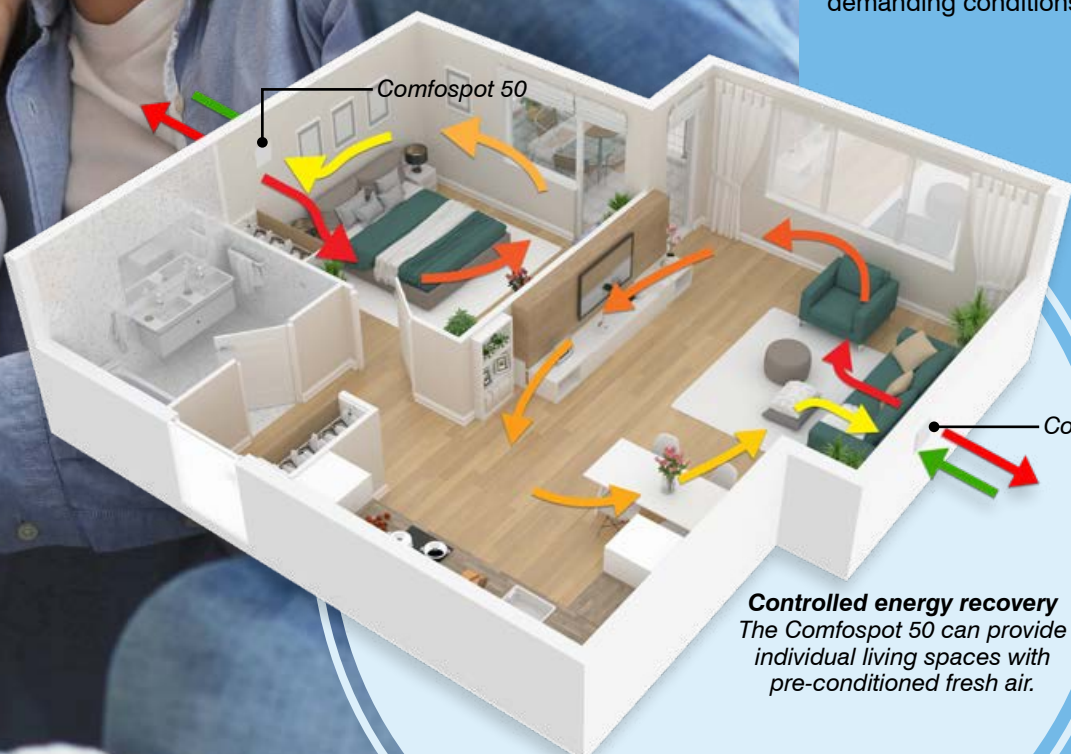

**Controlled energy recovery**  
The Comfospot 50 can provide individual living spaces with pre-conditioned fresh air.

## Specifications

Fan Motor	EC
Filter class	Supply/extract air ISO Coarse $\geq$ 70% (G4) (optionally supply air ISO ePM10 $\geq$ 60% (F7))
Heat emitter	Cross-counterflow enthalpy exchanger
Unit core	Expanded polypropylene (EPP)
Electrical connection	230 AC 50–60 Hz
Max. current draw	0.07 A
Power consumption	5 W to 15 W (standby: < 1 W)
Shutters	Manually operated shutters for supply and extract air
Energy efficiency	Up to 85% heat recovery Up to 74% humidity recovery
Weight	6 kg
Options	Humidity sensor board
	Humidity and CO <sub>2</sub> sensor board
	ComfoLED electronic control panel



## Operating Data

Operation Speed	Volume Flow m <sup>3</sup> /h	Thermal Efficiency %	Humidity Efficiency %	Power Consumption W	Noise Level dB(A) @ 3m
Fan speed 1	15	85	74	4	5.2
Fan speed 2	25	76	58	6	14.7
Fan speed 3	40	69	46	10	23.2
Fan speed 4	50	62	44	15	29



## Dimensional Data

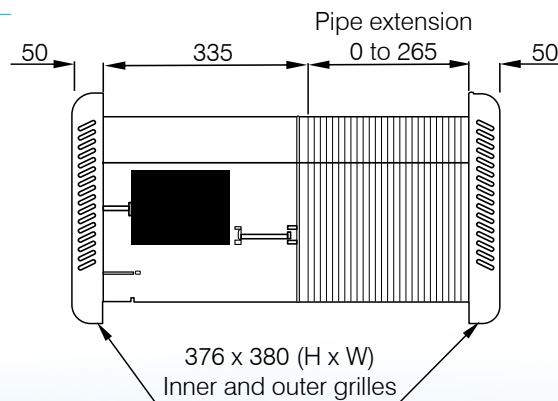
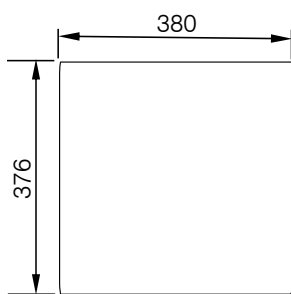

Dimensions in mm

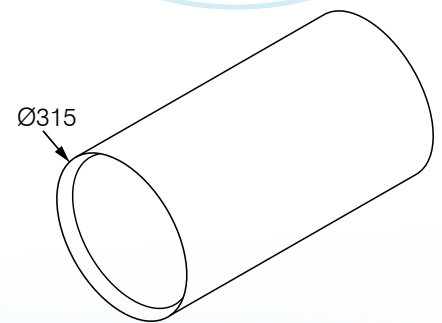

Supplied with wall tube sleeve



### Fantech Pty. Ltd.

Victoria: (+61 3) 9554 7845  
 New South Wales: (02) 8811 0400  
 South Australia: (08) 8294 0530  
 Northern Territory: (08) 8947 0447  
 Queensland: (07) 3299 9888  
 Western Australia: (08) 9209 4999  
 A.C.T.: (02) 6280 5511  
 New Zealand: (09) 444 6266

[www.mvhr.co.nz](http://www.mvhr.co.nz)

[www.energyrecovery.com.au](http://www.energyrecovery.com.au)



For sales enquiries contact:

[hrv@fantech.com.au](mailto:hrv@fantech.com.au)

Specifications and design subject to change without notice.